



KineticicoPRO™
Total Water Care

CC-SERIES WATER SOFTENERS

CC206s • CC206c • CC208s • CC208c

Importance of Water Softening

Hard water can cost you money! From increased service calls, water bills, scale-build to negatively impacting your guest experiences. In a nutshell, water flows through the ground and plumbing and picks up dissolved minerals as well as man-made and natural contaminants. These contaminants bring harmful buildup to your equipment and operations. Minerals such as calcium, magnesium, iron, and other deposits can have negative effects on equipment longevity, water pressure, dishware appearance, energy efficiency, and beverage clarity and quality. Ultimately, hard water can have a significant impact on your guest experiences and your bottom line.

CC-Series Water Softener Overview

KineticicoPRO's innovative non-electric Point-of-Use (POU) CC Series water softening systems are designed to provide soft water to applications across your back-of-house operations. Our POU systems are engineered to treat moderate levels of water hardness for low to medium water volume needs.



Guest Experience

- Innovative demand-driven regeneration system prolongs equipment life, which reduces downtime and delivers an elevated guest experience.



Operational Efficiency

- Non-electric system does not require timers or computers to set, adjust, repair or replace.
- Metered system regenerates based on actual water usage resulting in minimal salt use and maximum water efficiency.
- Counter-current regeneration method conserves water and salt, while eliminating hardness breakthrough.



Equipment Protection

- Twin tank design allows for 24/7 uninterrupted supply of soft water even during regeneration.
- Soft water regeneration method operates with 100% soft water, prolonging the life of the system.
- Corrosion-resistant valve and tanks designed to endure the harshest environments.



Environmentally Friendly

- Non-electric system powered by the kinetic energy of moving water.
- Auto-regeneration system helps to optimize both water and salt consumption.

90%

of Patrons report
having a negative
dining experience
due to dirty/spotted
tableware*

APPLICATION USE



Dishwashers

Eliminate spotted
tableware



Cleanliness

Reduce scaling &
optimize cleaning time



Water Heater

Improve efficiency &
reduce energy costs



Coffee/Tea/Espresso

Reduce hardness for
optimal flavor profile
(RO solutions available)



Steamers/Combi Ovens

Protect equipment
from hardness & scale

* Source: KineticicoPRO™ proprietary patron research study, July 2019.

CC-Series

SPECIFICATIONS

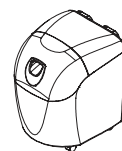
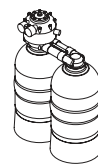
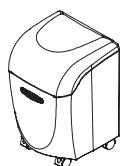
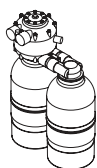

	CC206s	CC206c	CC208s	CC208c
Tank Size	6" x 13"	6" x 13"	8" x 17"	8" x 17"
Resin Volume	0.18 ft ³	0.18 ft ³	0.4 ft ³	0.4 ft ³
Service Flow	Up Flow	Up Flow	Up Flow	Down Flow
Brine Tank Capacity	Optional	40 lb	Optional	100 lb
Regeneration Volume	5 gal	5 gal	14 gal	9 gal
Peak Temperature	120°F	160°F	120°F	160°F
Continuous Temperature	100°F	150°F	100°F	150°F
Dimensions (W x D x H)	13" x 6" x 20"	14" x 14" x 22"	17" x 8" x 25"	20" x 24" x 28"

Half Louver Nozzle (standard) Part # 11018

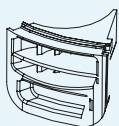

Flow Range	0.3 – 9.1 gpm	0.3 – 9.1 gpm	0.3 – 10.2 gpm	0.3-10.2 gpm
Meter Volume	583 gal	583 gal	732 gal	732 gal
Salt Used	0.5 / 1.0 lb	0.5 / 1.0 lb	1.0 / 1.4 lb	1.0 / 1.4 lb
Hardness Range	20 / 30 gpg	20 / 30 gpg	35 / 42 gpg	35 / 40 gpg

Micro Nozzle (optional) Part # 10880B

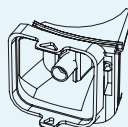

Flow Range	0.05 – 0.15 gpm	0.05 – 0.15 gpm	0.05 – 0.15 gpm	0.05 – 0.15 gpm
Meter Volume	61 gal	61 gal	61 gal	61 gal
Salt Used	0.5 lb	0.5 lb	1.0 lb	1.0 lb
Hardness Range	40	40	50	50
Flow Range	0.15 – 5.0 gpm	0.15 – 5.0 gpm	0.15 – 5.0 gpm	0.15 – 5.0 gpm
Meter Volume	250 gal	250 gal	315 gal	315 gal

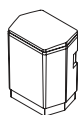

Brine Tank Options		
Systems	CC206s CC208s	CC208s
Tank Description	12" x 40"	12" x 40"
Material	HDPE	HDPE
Salt Capacity	50 lb	100 lb



**POE & POU
Water Softeners**



Water Filtration



RO Systems

EFFORTLESS TOTAL WATER CARE

KineticoPRO™ offers a complete range of commercial water treatment solutions. Based on a per-location water analysis, we will work with you to prescribe the ideal water filtration, softening, and reverse osmosis solutions to optimize your water quality and protect your equipment.